

**HR RQ2640 - AQ2640**

Fig 1

Programming of your new remote with an already programmed remote control:

Remove the protection cap from the battery.

1. Press simultaneously the two top buttons on the new remote. Release the buttons.
2. Press again at the same time on the top two buttons on the new remote. The LED of the new remote control flashes three times. Release the buttons.
3. Press the button you want to use. The LED of the new remote will flash once. Release the button.
4. Place the new remote and the original remote "back to back"
5. Press the button on the old remote, which you want to copy.
6. The LED on the new remote begins to flash rapidly, after a few seconds it will flash 3 times slowly.
7. Let go of the button on the original programmed remote.
8. Wait a few seconds. The new remote will flash once.
9. Your new remote control is now programmed.

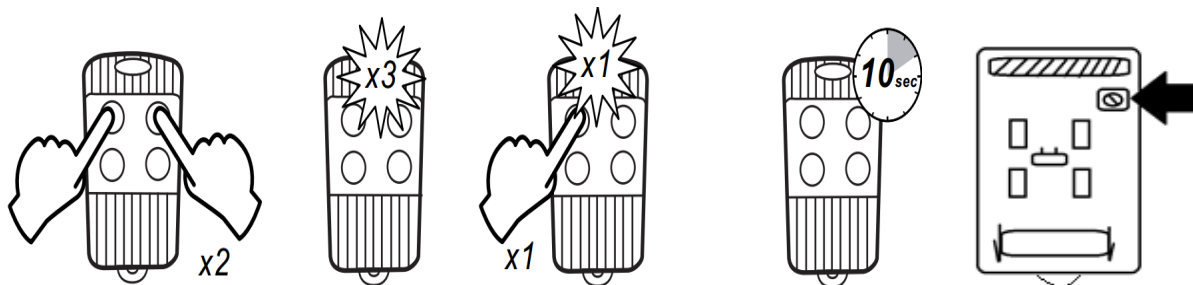
Note: You can program all other buttons on your remote with the same procedure.

Regulation of the transmission power of the new remote:

Note: If after programming the new remote it works only on a very short range (a few centimeters away from the motor or 1-2 m), replace the battery first.

If the problem persists, you can adjust the transmit power. Follow the instructions:

1. Open the new remote control completely.
2. On the board of the new remote is at the top right corner a small screw. (see Fig 1).
3. Go next to your engine, turn the screw and test the transmitter again.
4. At a certain point, the transmitter should operate normally.